

450

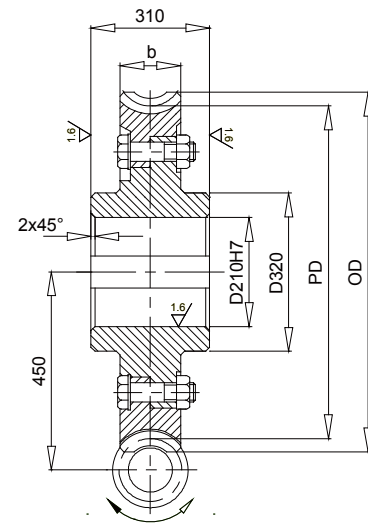

Ratio	Worms										Worm Gears					
	THC Gear #	Module	No. of Stars	OD	b	L1	L2	d1	d2	Weight (kg)	THC Gear #	No. of Teeth	PD	OD	b	Weight (kg)
10	STPW17.5-4RNG	17.50	4	252.88	227	380	210	165	155	226.0	BTPWG17.5-40R	40	700.0	742.0	145	399.0
12.5	STPW14.3-4RNG	14.30	4	234.43	228	380	250	165	155	228.0	BTPWG14.3-50R	50	715.0	750.0	140	398.0
16	STPW15-3RNG	15.00	3	229.04	226	380	280	160	150	210.0	BTPWG15-48R	48	720.0	756.0	135	386.0
20	STPW18.25-2RNG	18.25	2	218.06	232	380	300	165	155	225.0	BTPWG18.25-40R	40	730.0	760.0	130	400.0
25	STPW14.7-2RNG	14.70	2	215.92	235	380	310	160	150	209.0	BTPWG14.7-50R	50	735.0	771.0	120	388.0
31.5	STPW11.83-2RNG	11.83	2	199.55	223	380	330	155	145	194.0	BTPWG11.83-63R	63	745.0	775.0	118	377.0
40	STPW9.44-1RNG	9.44	1	188.57	228	380	330	165	155	226.0	BTPWG9.44-80R	80	755.0	778.0	112	400.0
50	STPW15.2-1RNG	15.20	1	192.96	244	380	350	160	150	209.0	BTPWG15.2-50R	50	760.0	797.0	100	387.0
63	STPW12.14-1RNG	12.14	1	179.79	226	380	360	155	145	194.0	BTPWG12.14-63R	63	765.0	795.0	100	378.0

Note:
 1 All dimensions are in mm.
 2 Dimensions and other engineering data are subject to change. Certified specifications are available on request.

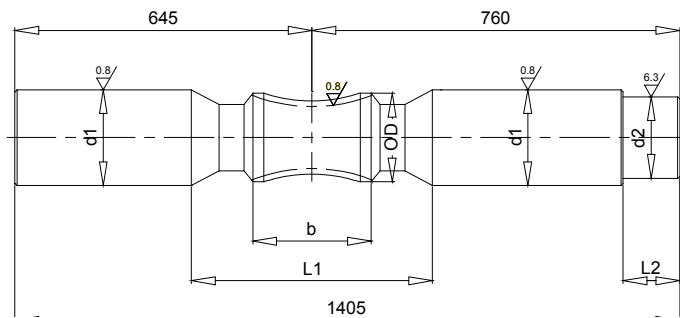
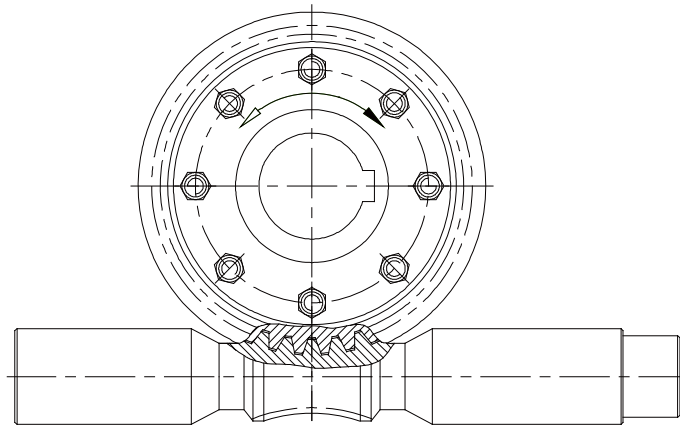

Specifications			
Item	Worm	Worm Gear	Worm Gear Hub
Hand of Helix	Right	Right	-
Material	42CrMo or 38CrMoAl	ZCuSn10Pb1	C45
Heat Treatment	Quenching and Tempering	-	Quenching and tempering
Tooth Surface Treatment	Nitriding	-	-
Tooth Surface Finish	Ground	Cut	-
Tooth Hardness	HRC55-60	HBW885	HB240-270
Precision Grade	GB 7	GB 7	-

Rated Power and Torques of Worms and Worm Sets

Ratio	n ₁	n ₂	P _{1N}	T _{2N}	η
	rpm	rpm	KW	N.m	%
10	1500	150	347	20988	95
	1000	100	320	29032	95
	750	75	270	32317	94
	500	50	217	38131	92
12.5	1500	120	304	22863	94.5
	1000	80	272	30684	94.5
	750	60	223	33010	93
	500	40	170	36935	91
16	1500	94	258	24442	93
	1000	63	233	33110	93
	750	47	189	35425	92
	500	31	146	39710	89
20	1500	75	217	25145	91
	1000	50	187	32502	91
	750	38	154	35297	90
	500	25	120	39881	87
25	1500	60	178	25215	89
	1000	40	152	32298	89
	750	30	130	36417	88
	500	20	97.4	39532	85
31.5	1500	48	144	24547	85
	1000	32	126	32218	85
	750	24	93.3	31435	84
	500	16	81.1	38547	79
40	1500	38	118	24341	81
	1000	25	97.4	30138	81
	750	19	85.2	34716	80
	500	13	62.9	36522	76
50	1500	30	95.3	23663	78
	1000	20	83.2	30988	78
	750	15	69	33826	77
	500	10	52.7	36740	73
63	1500	24	77.1	23194	75
	1000	16	69	31135	75
	750	12	62.9	37339	74
	500	8	42.6	35882	70

Note:
 1 All dimensions are in mm.
 2 Dimensions and other engineering data are subject to change. Certified specifications are available on request.