

400

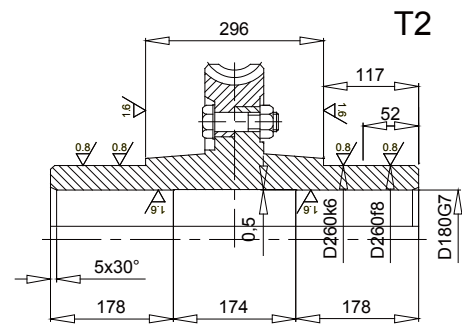

Ratio	Worms							Worm Gears						
	THC Gear #	Module	No. of Stars	OD	d	b	Weight (kg)	THC Gear #	No. of Teeth	PD	OD	b	Weight T1(kg)	Weight T2(kg)
10	STPW15.75-4RNG	15.75	4	217.49	-	205	87.0	BTPWG15.75-40R	40	630	668	125	278.0	328.0
12.5	STPW12.8-4RNG	12.80	4	204.53	-	205	88.0	BTPWG12.8-50R	50	640	671	120	276.0	326.0
16	STPW13.44-3RNG	13.44	3	199.06	-	202	83.0	BTPWG13.44-48R	48	645	678	115	278.0	328.0
20	STPW16.13-2RNG	16.13	2	203.58	-	210	86.0	BTPWG16.13-40R	40	645	685	110	278.0	330.0
25	STPW13-2RNG	13.00	2	194.98	-	208	74.0	BTPWG13-50R	50	650	681	110	279.0	328.0
31.5	STPW10.48-2RNG	10.48	2	179.12	-	196	79.0	BTPWG10.48-63R	63	660	686	105	278.0	329.0
40	STPW16.63-1RNG	16.63	1	185.89	-	217	86.0	BTPWG16.63-40R	40	665	705	92	278.0	328.0
50	STPW13.4-1RNG	13.40	1	176.49	-	214	83.0	BTPWG13.4-50R	50	670	703	92	278.0	328.0
63	STPW10.71-1RNG	10.71	1	166.17	-	205	80.0	BTPWG10.71-63R	63	675	701	92	278.0	328.0

Note:
 1 All dimensions are in mm.
 2 Dimensions and other engineering data are subject to change. Certified specifications are available on request.

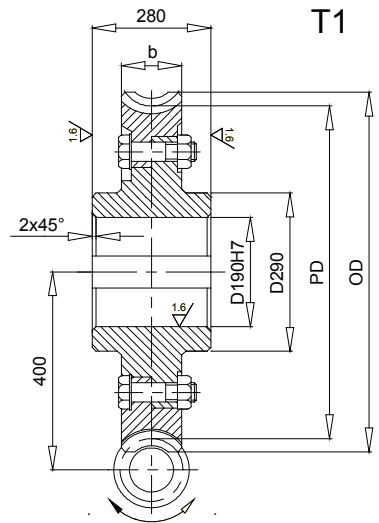

Specifications			
Item	Worm	Worm Gear	Worm Gear Hub
Hand of Helix	Right	Right	-
Material	42CrMo or 38CrMoAl	ZCuSn10Pb1	C45
Heat Treatment	Quenching and Tempering	-	Quenching and tempering
Tooth Surface Treatment	Nitriding	-	-
Tooth Surface Finish	Ground	Cut	-
Tooth Hardness	HRC55-60	HBW885	HB240-270
Precision Grade	GB 7	GB 7	-

Rated Power and Torques of Worms and Worm Sets

Ratio	n ₁	n ₂	P _{1N}	T _{2N}	η
	rpm	rpm	KW	N.m	%
10	1500	150	261	15786	95
	1000	100	241	21865	95
	750	75	203	24298	94
	500	50	163	28642	92
12.5	1500	120	229	17222	94.5
	1000	80	205	23126	94.5
	750	60	168	24868	93
	500	40	128	27810	91
16	1500	94	194	18379	93
	1000	63	176	25010	93
	750	47	142	26616	92
	500	31	110	29918	89
20	1500	75	163	18887	91
	1000	50	140	24333	91
	750	38	116	26587	90
	500	25	90.1	29944	87
25	1500	60	134	18982	89
	1000	40	114	24224	89
	750	30	97.7	27369	88
	500	20	73.3	29751	85
31.5	1500	48	108	18410	85
	1000	32	94.6	24189	85
	750	24	70.2	23652	84
	500	16	61.1	29041	79
40	1500	38	88.5	18256	81
	1000	25	73.3	22680	81
	750	19	64.1	26119	80
	500	13	47.3	27464	76
50	1500	30	71.7	17803	78
	1000	20	62.6	23315	78
	750	15	51.9	25443	77
	500	10	39.7	27677	73
63	1500	24	58	17448	75
	1000	16	51.9	23419	75
	750	12	47.3	28079	74
	500	8	32.1	27038	70

Note:
 1 All dimensions are in mm.
 2 Dimensions and other engineering data are subject to change. Certified specifications are available on request.