

225

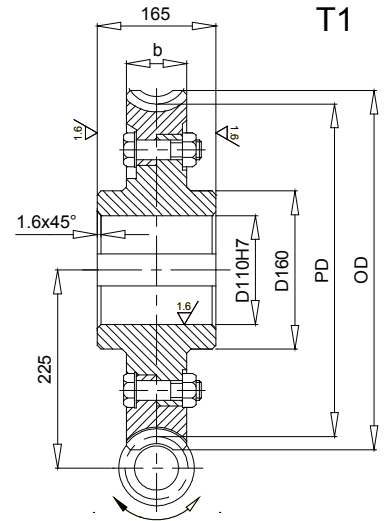

T1

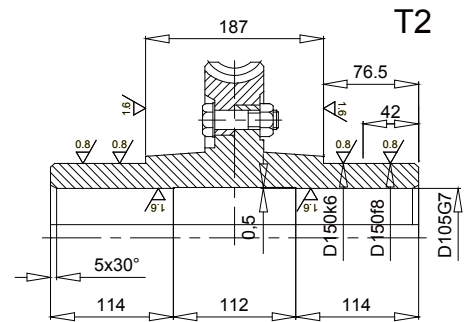

T2

Ratio	Worms							Worm Gears						
	THC Gear #	Module	No. of Stars	OD	d	b	Weight (kg)	THC Gear #	No. of Teeth	PD	OD	b	Weight T1(kg)	Weight T2(kg)
10	STPW8.75-4RNG	8.75	4	124.00	85	113	20.3	BTPWG8.75-40R	40	350	371	73	47.5	63.5
12.5	STPW7.1-4RNG	7.10	4	117.48	85	114	19.6	BTPWG7.1-50R	50	355	372	72	47.3	63.3
16	STPW7.4-3RNG	7.40	3	117.91	85	114	20.2	BTPWG7.4-48R	48	355	373	70	48.3	64.3
20	STPW9-2RNG	9.00	2	114.56	85	116	19.5	BTPWG9-40R	40	360	382	64	47.7	63.7
25	STPW7.3-2RNG	7.30	2	107.96	85	116	19.5	BTPWG7.3-50R	50	365	383	62	47.1	63.1
31.5	STPW5.87-2RNG	5.87	2	100.74	85	113	20.6	BTPWG5.87-63R	63	370	384	60	47.5	63.5
40	STPW9.38-1RNG	9.38	1	101.14	85	122	20.0	BTPWG9.38-40R	40	375	398	52	47.3	63.3
50	STPW7.5-1RNG	7.50	1	98.44	85	119	19.7	BTPWG7.5-50R	50	375	393	54	47.0	63.0
63	STPW6.03-1RNG	6.03	1	91.16	85	116	19.2	BTPWG6.03-63R	63	380	395	52	48.2	64.2

Note:
 1 All dimensions are in mm.
 2 Dimensions and other engineering data are subject to change. Certified specifications are available on request.



Specifications			
Item	Worm	Worm Gear	Worm Gear Hub
Hand of Helix	Right	Right	-
Material	42CrMo or 38CrMoAl	ZCuSn10Pb1	C45
Heat Treatment	Quenching and Tempering	-	Quenching and tempering
Tooth Surface Treatment	Nitriding	-	-
Tooth Surface Finish	Ground	Cut	-
Tooth Hardness	HRC55-60	HBW885	HB240-270
Precision Grade	GB 7	GB 7	-

Rated Power and Torques of Worms and Worm Sets

Ratio	n ₁	n ₂	P _{1N}	T _{2N}	η
	rpm	rpm	KW	N.m	%
10	1500	150	81.4	4872	94
	1000	100	75.2	6751	94
	750	75	63.3	7496	93
	500	50	50.9	8847	91
12.5	1500	120	71.4	5313	93.5
	1000	80	63.8	7121	93.5
	750	60	52.3	7658	92
	500	40	40	8595	90
16	1500	94	60.4	5661	92
	1000	63	54.7	7690	92
	750	47	44.3	8213	91
	500	31	34.3	9224	88
20	1500	75	50.9	5833	90
	1000	50	43.8	7529	90
	750	38	36.2	8251	89.5
	500	25	28.1	9231	86
25	1500	60	41.9	5902	88.5
	1000	40	35.7	7543	88.5
	750	30	30.5	8447	87
	500	20	22.8	9036	83
31.5	1500	48	33.8	5694	84
	1000	32	29.5	7454	84
	750	24	21.9	7291	83
	500	16	19	8916	78
40	1500	38	27.6	5623	80
	1000	25	22.8	6968	80
	750	19	20	8047	79
	500	13	14.8	8480	75
50	1500	30	22.4	5491	77
	1000	20	19.5	7170	77
	750	15	16.2	7839	76
	500	10	12.4	8526	72
63	1500	24	18.1	5372	74
	1000	16	16.2	7213	74
	750	12	14.8	8667	73
	500	8	9.99	8294	69

Note:

1 All dimensions are in mm.

2 Dimensions and other engineering data are subject to change. Certified specifications are available on request.