

Specifications	
Pressure Angle	20°
Material	C45
Heat Treatment	-
Tooth Surface Treatment	-
Tooth Surface Finish	Milled
Precision Grade	ISO 8

Gear #	Module	Number of Teeth	Type	PD	OD	d	F	L	I1	I2	Set Screw
SS0.15-15	0.15	15	T3	2.295	2.595	*1.5	1.7	-	-	-	-
SS0.2-12	0.2	12	T3	2.452	2.852	*1.5	1.7	-	-	-	-
SS0.25-13	0.25	13	T3	3.250	3.750	*2	2.5	-	-	-	-
SS0.25-13	0.25	13	T3	3.250	3.750	*1.5	4.0	-	-	-	-
SS0.25-16	0.25	16	T3	3.900	4.400	*2	2.5	-	-	-	-
SS0.25-16	0.25	16	T3	3.900	4.400	*1.5	4.0	-	-	-	-
SS0.25-19	0.25	19	T3	4.750	5.250	*2	2.5	-	-	-	-
SS0.25-19	0.25	19	T3	4.750	5.250	*1.5	4.0	-	-	-	-
SS0.4-12	0.4	12	T3	4.880	5.680	*3	4.0	-	-	-	-
SS0.4-14	0.4	14	T3	4.880	5.680	*3	4.0	-	-	-	-
SS0.5-12	0.5	12	T3	6.200	7.200	*4	4.0	-	-	-	-
SS0.6-12	0.6	12	T3	7.200	8.400	#4	4.0	-	-	-	-
SS0.6-12	0.6	12	T3	7.200	8.400	#3	4.0	-	-	-	-
SS0.6-12	0.6	12	T3	7.200	8.400	#2	4.0	-	-	-	-
SS0.6-18	0.6	18	T3	10.700	11.900	#4	4.0	-	-	-	-
SS0.6-18	0.6	18	T3	10.700	11.900	#3	4.0	-	-	-	-
SS0.6-18	0.6	18	T3	10.700	11.900	#2	4.0	-	-	-	-
SS0.6-24	0.6	24	T3	14.300	15.500	#4	4.0	-	-	-	-
SS0.6-24	0.6	24	T3	14.300	15.500	#3	4.0	-	-	-	-
SS0.6-24	0.6	24	T3	14.300	15.500	#2	4.0	-	-	-	-
SS1-8	1	8	T1	8.000	10.640	6 _{h8}	12.0	60	16	32	-
SS1-10	1	10	T1	10.000	12.660	8 _{h8}	12.0	60	16	32	-
SS1-12	1	12	T2	12.000	14.000	l6	12.0	30	18	5	M4
SS1-14	1	14	T2	14.000	16.000	l6	12.0	30	18	5	M5
SS1-15	1	15	T2	15.000	17.000	l6	12.0	30	18	5	M5
SS1-16	1	16	T2	16.000	18.000	l8	12.0	30	18	5	M5
SS1-18	1	18	T2	18.000	20.000	l8	12.0	30	18	4	M4

Note: ! Bore Tolerance: 6mm +0.018
8mm +0.022
* Bore Tolerance: 1.5mm -0.01, -0.03
2mm -0.01, -0.03
3mm -0.014, -0.03
4mm -0.02, -0.04
Bore Tolerance: 2mm -0.010, -0.025
3mm -0.015, -0.035
4mm -0.015, -0.035

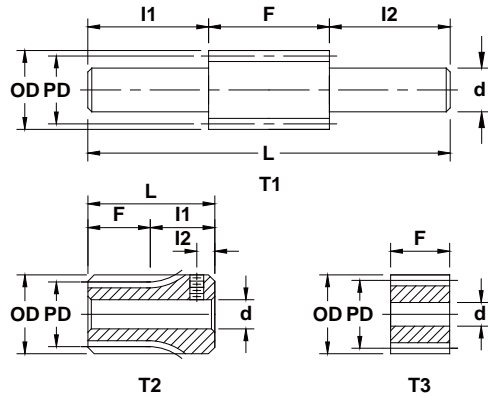

Specifications	
Pressure Angle	20°
Material	Brass
Heat Treatment	-
Tooth Surface Treatment	-
Tooth Surface Finish	Milled
Precision Grade	ISO 8

Gear #	Module	Number of Teeth	Type	PD	OD	d	F	L	I1	I2	Set Screw
BS0.15-15	0.15	15	T3	2.295	2.595	*1.5	1.7	-	-	-	-
BS0.2-12	0.2	12	T3	2.452	2.852	*1.5	1.7	-	-	-	-
BS0.25-13	0.25	13	T3	3.250	3.750	*2	2.5	-	-	-	-
BS0.25-13	0.25	13	T3	3.250	3.750	*1.5	4.0	-	-	-	-
BS0.25-16	0.25	16	T3	3.900	4.400	*2	2.5	-	-	-	-
BS0.25-16	0.25	16	T3	3.900	4.400	*1.5	4.0	-	-	-	-
BS0.25-19	0.25	19	T3	4.750	5.250	*2	2.5	-	-	-	-
BS0.25-19	0.25	19	T3	4.750	5.250	*1.5	4.0	-	-	-	-
BS0.4-12	0.4	12	T3	4.880	5.680	*3	4.0	-	-	-	-
BS0.4-14	0.4	14	T3	4.880	5.680	*3	4.0	-	-	-	-
BS0.5-12	0.5	12	T3	6.200	7.200	*4	4.0	-	-	-	-
BS0.6-12	0.6	12	T3	7.200	8.400	#4	4.0	-	-	-	-
BS0.6-12	0.6	12	T3	7.200	8.400	#3	4.0	-	-	-	-
BS0.6-12	0.6	12	T3	7.200	8.400	#2	4.0	-	-	-	-
BS0.6-18	0.6	18	T3	10.700	11.900	#4	4.0	-	-	-	-
BS0.6-18	0.6	18	T3	10.700	11.900	#3	4.0	-	-	-	-
BS0.6-18	0.6	18	T3	10.700	11.900	#2	4.0	-	-	-	-
BS0.6-24	0.6	24	T3	14.300	15.500	#4	4.0	-	-	-	-
BS0.6-24	0.6	24	T3	14.300	15.500	#3	4.0	-	-	-	-
BS0.6-24	0.6	24	T3	14.300	15.500	#2	4.0	-	-	-	-
BS1-8	1	8	T1	8.000	10.640	6 _{h8}	12.0	60	16	32	-
BS1-10	1	10	T1	10.000	12.660	8 _{h8}	12.0	60	16	32	-
BS1-12	1	12	T2	12.000	14.000	l6	12.0	30	18	5	M4
BS1-14	1	14	T2	14.000	16.000	l6	12.0	30	18	5	M5
BS1-15	1	15	T2	15.000	17.000	l6	12.0	30	18	5	M5
BS1-16	1	16	T2	16.000	18.000	l8	12.0	30	18	5	M5
BS1-18	1	18	T2	18.000	20.000	l8	12.0	30	18	4	M4

Note: ! Bore Tolerance: 6mm +0.018
8mm +0.022
* Bore Tolerance: 1.5mm -0.01, -0.03
2mm -0.01, -0.03
3mm -0.014, -0.03
4mm -0.02, -0.04
Bore Tolerance: 2mm -0.010, -0.025
3mm -0.015, -0.035
4mm -0.015, -0.035