

| Specifications | |
|-------------------------|------------------|
| Pressure Angle | 20° |
| Material | Acetal |
| Heat Treatment | - |
| Tooth Surface Treatment | - |
| Tooth Surface Finish | Injection Molded |
| Precision Grade | ISO 8 |

| Gear # | Module | Number of Teeth | Type | PD | OD | d | D | F | H | h | h1 | h2 |
|---------------|--------|-----------------|------|----|------|----|------|------|------|------|------|------|
| CM0.5-16M | 0.5 | 16 | T1 | 8 | 8.7 | 3 | 7 | 2.0 | 10.5 | 8.0 | 8 | 6 |
| CM1-16M | 1 | 16 | T1 | 16 | 17.6 | 5 | 12 | 4.7 | 18.4 | 13.6 | - | 8 |
| CM1.5-16M | 1.5 | 16 | T1 | 24 | 26.4 | 8 | 18.5 | 7 | 25.8 | 18.4 | 16.2 | 10 |
| CM2-16-8M | 2 | 16 | T1 | 32 | 34.9 | 8 | 21.9 | 10 | 30.4 | 21.2 | 18.3 | 9.6 |
| CM2-16-10M | 2 | 16 | T1 | 32 | 34.9 | 10 | 21.9 | 10 | 30.4 | 21.2 | 18.3 | 9.6 |
| CM2.5-16-8M | 2.5 | 16 | T1 | 40 | 43.5 | 8 | 25.2 | 12.3 | 37 | 25.5 | 22.9 | 11.5 |
| CM2.5-16-12M | 2.5 | 16 | T1 | 40 | 43.5 | 12 | 25.2 | 12.3 | 37 | 25.5 | 22.9 | 11.5 |
| CM3-16-14M | 3 | 16 | T1 | 48 | 52.3 | 14 | 28.8 | 13.8 | 43 | 29.2 | 25.8 | 13.2 |
| CM3-16-15M | 3 | 16 | T1 | 48 | 52.3 | 15 | 28.8 | 13.8 | 43 | 29.2 | 25.8 | 13.2 |
| CM3-16-17M | 3 | 16 | T1 | 48 | 52.3 | 17 | 28.8 | 13.8 | 43 | 29.2 | 25.8 | 13.2 |
| CM3-16-20M | 3 | 16 | T1 | 48 | 52.3 | 20 | 28.8 | 13.8 | 43 | 29.2 | 25.8 | 13.2 |
| CM3.5-16-18M | 3.5 | 16 | T1 | 56 | 18 | 18 | 33.3 | 15.8 | 49.5 | 33.1 | 28.1 | 14.4 |
| CM-3.5-16-20M | 3.5 | 16 | T1 | 56 | 20 | 20 | 33.3 | 15.8 | 49.5 | 33.1 | 28.1 | 14.4 |
| CM0.5-20M | 0.5 | 20 | T3 | 10 | 3 | 3 | 8 | 2.5 | 11 | 8 | 7 | 4 |
| CM0.8-20M | 0.8 | 20 | T3 | 16 | 5 | 5 | 12 | 3.5 | 16 | 10.8 | 10 | 5 |
| CM1-20M | 1 | 20 | T3 | 20 | 6 | 6 | 16 | 4.5 | 21 | 14.6 | 13 | 7 |
| CM1.5-20M | 1.5 | 20 | T3 | 30 | 8 | 8 | 20 | 7 | 30 | 20.6 | 19 | 10 |
| CM1-30M | 1 | 30 | T2 | 30 | 6 | 6 | 15 | 7.2 | 24.8 | 15.3 | 12.9 | 7.5 |

Note: Dimensions (in millimeters unless otherwise indicated) and other engineering data are subject to change. Certified specifications are available on request.

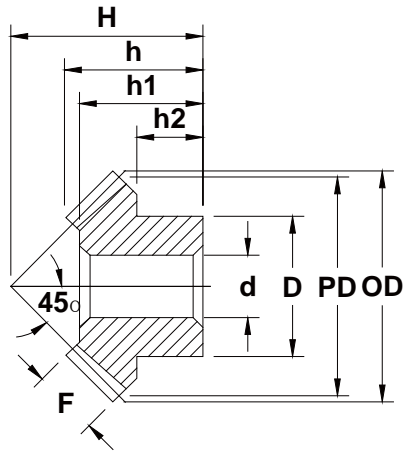

| Specifications | |
|-------------------------|----------|
| Pressure Angle | 20° |
| Material | Zinc |
| Heat Treatment | - |
| Tooth Surface Treatment | - |
| Tooth Surface Finish | Die Cast |
| Precision Grade | ISO 8 |

| Gear # | Module | Number of Teeth | PD | OD | d | D | F | H | h | h1 | h2 |
|-----------|--------|-----------------|----|------|----|----|------|------|------|------|------|
| ZM1-16D | 1 | 16 | 16 | 17.3 | 6 | 12 | 4.5 | 17.7 | 13.1 | 13.1 | 7.5 |
| ZM1.5-16D | 1.5 | 16 | 24 | 26 | 8 | 19 | 6.7 | 25.7 | 18.6 | 17 | 10.8 |
| ZM2-16D | 2 | 16 | 32 | 34.6 | 10 | 23 | 9.6 | 30 | 21.3 | 19.2 | 10 |
| ZM2.5-16D | 2.5 | 16 | 40 | 43.3 | 12 | 26 | 12.3 | 36 | 25.5 | 22.9 | 12 |
| ZM3-16D | 3 | 16 | 48 | 52.3 | 14 | 30 | 14 | 42.5 | 29.3 | 26 | 13 |
| ZM3.5-16D | 3.5 | 16 | 56 | 61.5 | 16 | 34 | 15.5 | 49.4 | 33.2 | 29.1 | 14 |

Note: Dimensions (in millimeters unless otherwise indicated) and other engineering data are subject to change. Certified specifications are available on request.